

TECHNICAL DATA

Rated voltage	500 V
Rated connection current	100 A
Rated fuse-link current	16 A
Conductor cross-section of the sector cable	16+50mm ² (*)
Number of cable conductors	1-5-4 pcs.
Tightening torque of the cable conductors	5.5 Nm
Max. conductor cross section of the luminaire cable	4 mm ²
Max. conductor cross section of neutral conductor	4 mm ²
Protection class	II
IP protection class	54
IZK 4-01 fuse-link IZK-2-01a	D01 gL WTz E27

(*) A smaller cross-section may be used provided that there is good contact between conductive parts.

Installation instructions for IZK connectors

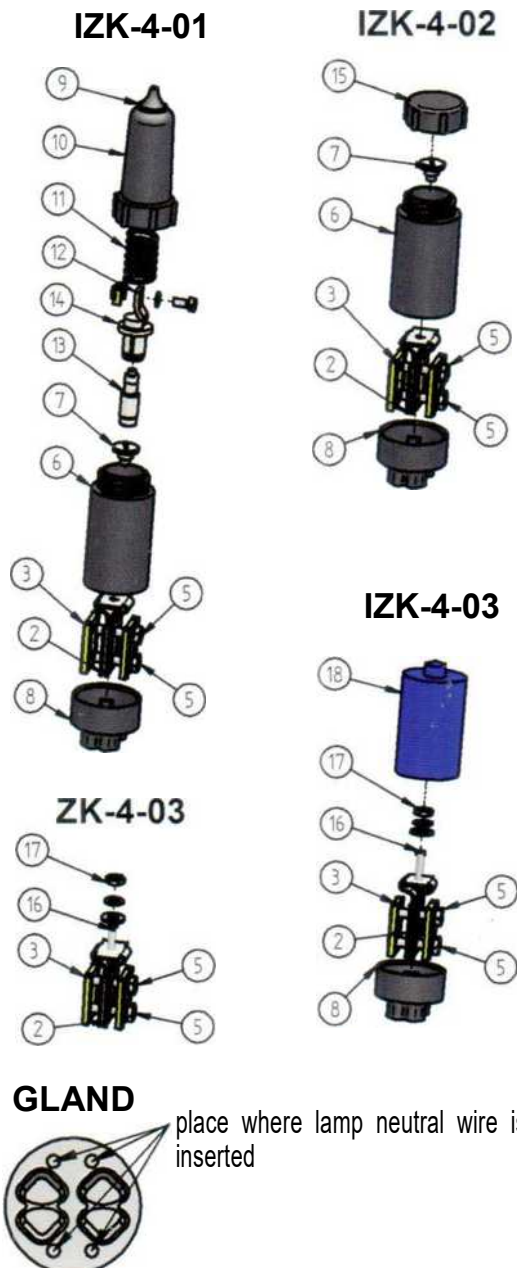

Installation instructions for Insulating Fuse-link Connector IZK-4-01:

1. Pull out the cables from the post bay.
2. Remove the outer insulation of the cables so that the insulated cable conductors can be freely bent off.
3. Remove approx. 35 mm of insulation length from the conductors.
4. Slide the cable gland 8 onto the insulated conductors.
5. Unscrew housing 10.
6. Unscrew the contact screw 7.
7. Remove housing 6 from body 2.
8. Loosen body 2 and plate 3 with screws 5.
9. Slide the uninsulated part of the conductors between the steel plate 3 and the tin-plated brass body 2.
10. Tighten the screws 5 with a torque wrench (torque 5 Nm).
11. Slide the assembled body into the housing 6 and tighten the contact screw 7.
12. Slide gland 8 over housing 6.
13. Route the phase cable of the lamp through grommet 9, housing 10 and spring 11.
14. Assemble the uninsulated end of the wire with the end of wire 12.
15. Slide fuse 13 into bracket 14.
16. Insert spring 11, bracket 14 with fuse 13 into housing 10 and screw it onto housing 6.

Installation instructions for Insulating Phase Connector IZK-4-02:

1. Perform steps 1-4 according to the installation instructions of the Insulating Fuse-link Connector IZK-4-01
2. Unscrew nut 15.
3. Perform steps 6-12 according to the installation instructions of the Insulating Fuse-link Connector IZK-4-01
4. Screw nut 15 onto housing 6.

Installation Instructions for Insulating Neutral Connector IZK-4-03:

1. Perform steps 1-4 according to the installation instructions of the Insulating Fuse-link Connector IZK-4-01.
2. Unscrew housing 18.
3. Perform steps 8-10 according to the installation instructions of the Insulating Fuse-link Connector IZK-4-01
4. Pull the lamp neutral wire through the hole in gland 8 (see the sketch on the side).
5. Connect the neutral wire feeding the luminaire by placing the wire eyelet onto screw 16, attach washers and tighten with nut 17.
6. Screw housing 18 onto screw 16 and slide gland 8 onto housing 18.

ZK-4-04 Neutral Connector Installation Instructions:

1. Perform steps 1 and 2 according to the installation instructions of the Insulating Fuse-link Connector IZK-4-01.
2. Perform steps 3 and 5 according to the installation instructions for the IZK-4-03 Insulated Neutral Connector.

Installation must be carried out in accordance with the safety regulations required for operation on power lines.